

**NEW!**  
**Thermoplastic Multi-Port Selector Valve**



**Standard Features:**

- 100% individually tested
- Corrosion resistant - no wetted metals either internal or external
- Self-lubricating machined PTFE rotor assures smooth operation and eliminates need for lubrication
- Compact size
- Fully customized for unique multi-port requirements
- Electric and Pneumatic actuation available
- Stackable for manifold applications

**Ideal For:**

- Pilot and process sampling
- Chromatography
- Remote control and positioning
- Research and development
- Cleaning Systems

**Materials of Construction:**

Valve bodies are available in Grade 1, Type 1 PVC, CPVC, Beige Polypro, PVDF or PTFE. Shaft material matches body material. Self-lubrication rotor is PTFE; elastomer seals are FKM. Handle ABS. There are no wetted metals.

**Design Considerations and Flow Configurations:**

**2-Way Drillings**

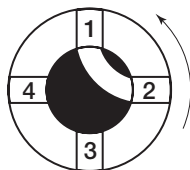

Handle Turn 90°

**3-Way Drillings**

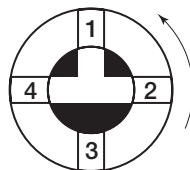

Handle Turn 90°

**4-Way Drillings**

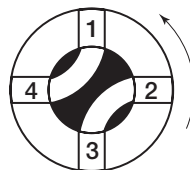

Handle Turn 90°

**5-Way Drillings**

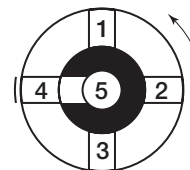

Handle Turn 360°

Valve design uses a pre-drilled PTFE rotor to distribute flow to multiple ports.

The “wiping” action of the rotor can create momentary cross-contamination between ports.

The flow patterns depicted above are standard; valves are fully customizable and stackable to create multi-level valves and manifolds. With actuation packages, Selector Valves provide unlimited flexibility in developing multi-port control systems. Please contact our Technical Services group at 973-256-3000 to discuss your specific application.



**PLAST-O-MATIC VALVES, INC.**

1384 Pompton Avenue, Cedar Grove, New Jersey 07009  
 (973) 256-3000 • Fax (973) 256-4745 • www.plastomatic.com

# Thermoplastic Selector Valve

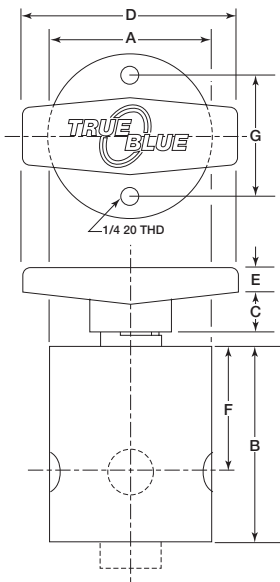

		Dimensions														
	Cv Factor	Pipe Size	A		B		C		D		E		F		G	
			In.	MM	In.	MM	In.	MM	In.	MM	In.	MM	In.	MM	In.	MM
2-Way Selector	1.115	1/4"	2.00	51	2.00	51	0.44	11	3.00	76	0.81	21	1.00	25	1.38	35
	3.69	1/2"	2.50	64	2.88	73	0.56	14	3.00	76	0.81	21	1.50	38	2.00	51
3-Way Selector	1.15	1/4"	2.00	51	2.00	51	0.44	11	3.00	76	0.81	21	1.00	25	1.38	35
	3.69	1/2"	2.50	64	2.88	73	0.56	14	3.00	76	0.81	21	1.50	38	2.00	51
4-Way Selector	0.55	1/4"	2.00	51	2.00	51	0.44	11	3.00	76	0.81	21	1.00	25	1.38	35
	2.40	1/2"	2.50	64	2.88	73	0.56	14	3.00	76	0.81	21	1.50	38	2.00	51
5-Way Selector	1.15	1/4"	2.00	51	2.50	64	0.44	11	3.00	76	0.81	21	1.00	25	1.38	35
	3.69	1/2"	2.50	64	2.88	73	0.56	14	3.00	76	0.81	21	1.50	38	2.00	51

## Part Number

### 1/4" Pipe Size

Body Material	PVC	CPVC	Polypro	PVDF	PTFE
2-Way	S025-V-2-PV	S025-V-2-CP	S025-V-2-PP	S025-V-2-PF	S025-V-2-TF
3-Way	S025-V-3-PV	S025-V-3-CP	S025-V-3-PP	S025-V-3-PF	S025-V-3-TF
4-Way	S025-V-4-PV	S025-V-4-CP	S025-V-4-PP	S025-V-4-PF	S025-V-4-TF
5-Way	S025-V-5-PV	S025-V-5-CP	S025-V-5-PP	S025-V-5-PF	S025-V-5-TF

### 1/2" Pipe Size

2-Way	S050-V-2-PV	S050-V-2-CP	S050-V-2-PP	S050-V-2-PF	S050-V-2-TF
3-Way	S050-V-3-PV	S050-V-3-CP	S050-V-3-PP	S050-V-3-PF	S050-V-3-TF
4-Way	S050-V-4-PV	S050-V-4-CP	S050-V-4-PP	S050-V-4-PF	S050-V-4-TF
5-Way	S050-V-5-PV	S050-V-5-CP	S050-V-5-PP	S050-V-5-PF	S050-V-5-TF

## Pressure / Temperature De-Rating Chart

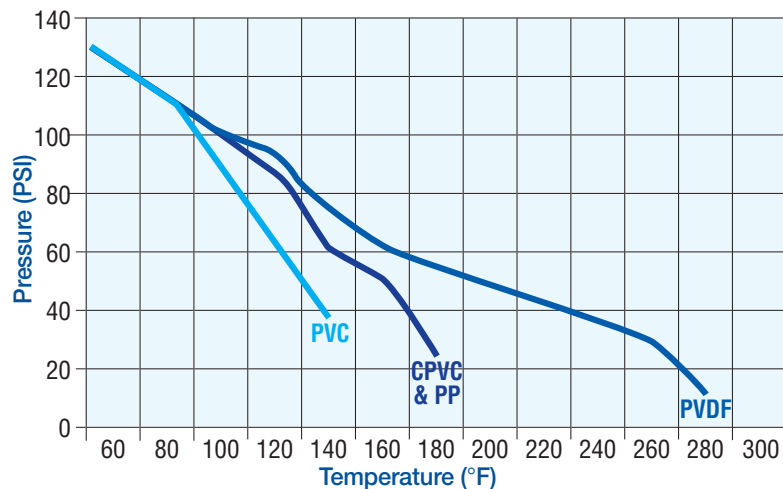

**PLAST-O-MATIC**  
VALVES, INC.

1384 Pompton Avenue, Cedar Grove, NJ 07009-1095  
(973) 256-3000 • Fax (973) 256-4745  
www.plastomatic.com • info@plastomatic.com

AUTHORIZED PLAST-O-MATIC DISTRIBUTOR